

# ***Release Notes***

## ***5000 series 4.6.4***

*11 Aug 2025*

# ***New firmware for the 5000 series***

**DATAMARS**  
***Livestock™***

Release date: 11 Aug 2025

What's included?

- ✓Improvement to Bluetooth connections (Bluetooth Classic)
- ✓JR5000 now has redraft feature
- ✓Draft direction supports larger count
- ✓Te Pari loadbars now supported
- ✓Hungary language added
- ✓New favourites for NZ and Australia regions
- ✓Better error management for underload/overload
- ✓Telemetry subsystem enabled



# Improvement to Bluetooth Connections

We have made several improvements to the Bluetooth connection method of the 5000 series including:

- The 5000 series will no longer attempt to connect to devices that aren't available
- The scanning and availability windows have been improved
- On the connections screen, changed wording to 'forget device' to unpair a device.

Note this is for Bluetooth Classic, we are releasing Bluetooth LE in the next release.

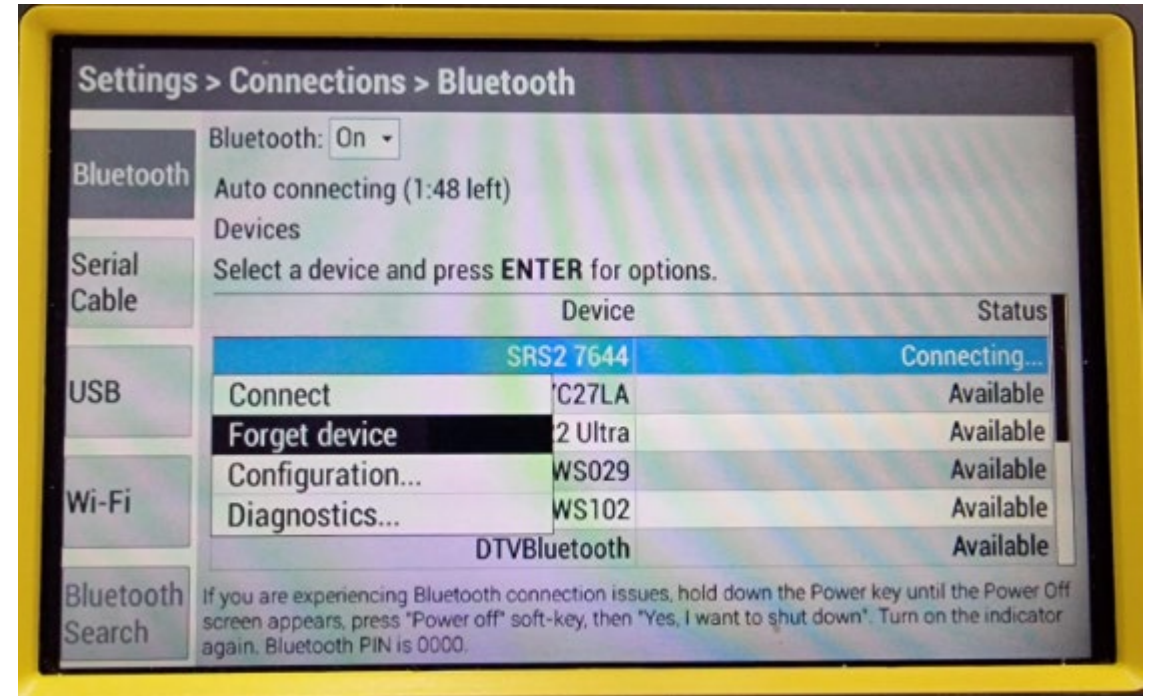

# Drafting Improvements

- JR5000 now has recalculate draft feature
  - This feature was already included in the ID and XR models.
- Draft direction supports higher count
  - When drafting large amount of animals, the drafting direction count now supports up to 99,999 animals in each direction (previously 999).



# New Features

- Hungarian Language now Available
  - In the first start up screen, the Hungarian language – Magyar – is now available
- Te Pari load bars now supported
  - Several Te Pari load bars have been added to our weighing settings. Note that these may not be auto detectable when plugged it and the customer may need to go to weigh settings to select the load bar type.

**DATAMARS**  
***Livestock***<sup>™</sup>

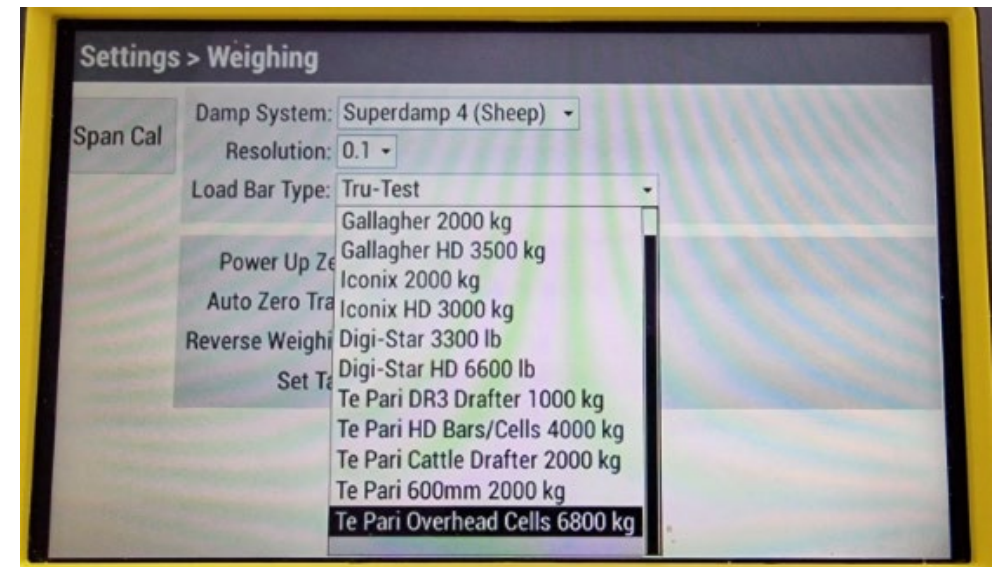
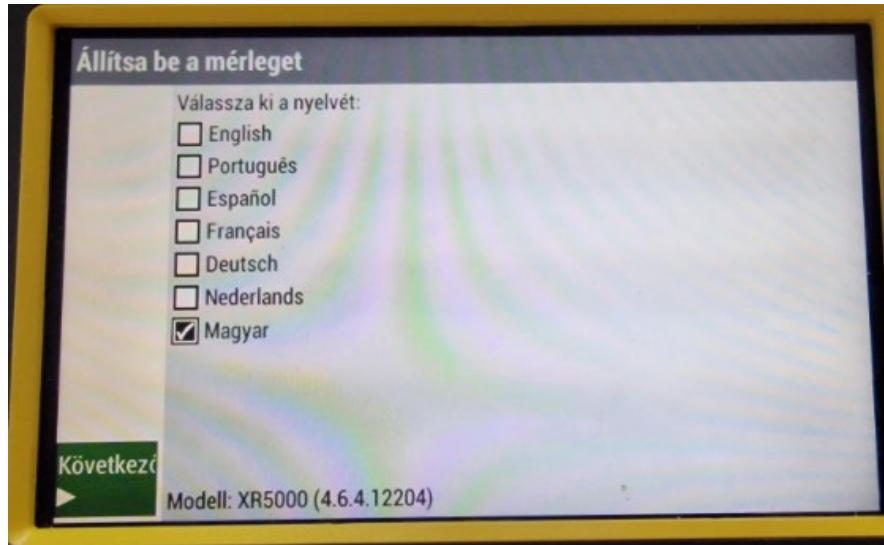



# ***New Favourites for ANZ regions***

We have added new favourites to the 5000 series that focus on sheep drafting.

These are available to customers that select the country Australia or New Zealand in the start up menu.

These favourites will be added to other regions in the next release once translations are complete.

Settings > Favourites

Save new or highlight existing favourite below, then choose an action.

Use

Delete

Save New

Name	Description	Date Modified
Auto Draft by Weight No ID Sheep	Automatically sort sheep 3 ways by weight with a 4th stop option. No ID recorded. Recommended for sheep auto drafting systems.	04:16 pm 26/02/2025
Auto Draft by Weight With ID	Automatically sort sheep 3 ways by weight with a 4th stop option. Recorded automatically when ID is received.	04:25 pm 26/02/2025
Basic weigh	Manually record cattle weight with no ID tag	02:30 am 18/10/2022
Draft by Weight No ID Cattle	Sort cattle 3-way by Weight. Manually record	04:03 pm 26/02/2025

# Improvement Underload/Overload error

We have improved the error handling for the underload/overload/bas cell code message to provide more guidance on how to handle this.

When customers see underload or overload error on their weigh screen, they now have a QR code directs them to our knowledge base help article.

This will guide them through several checks before they need to contact customer support.

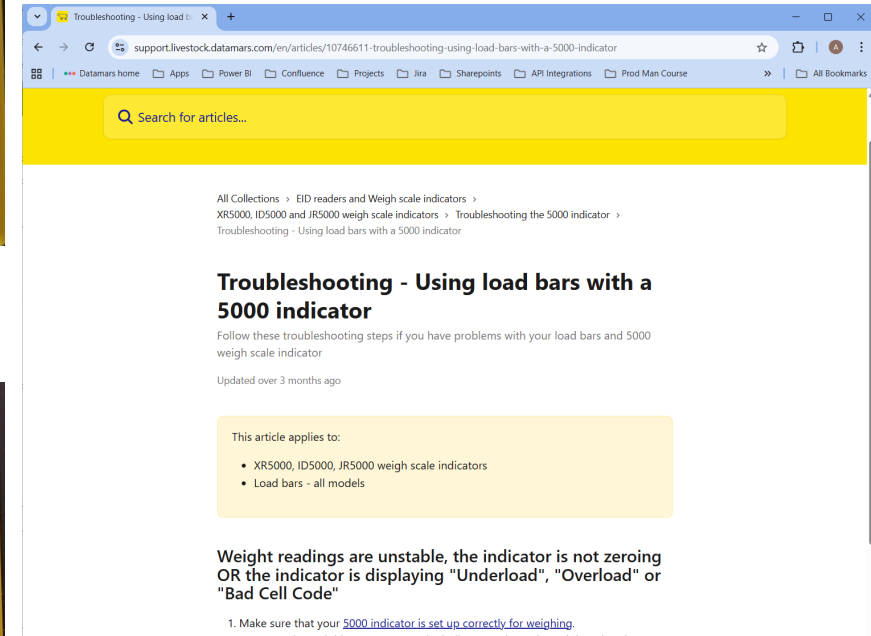
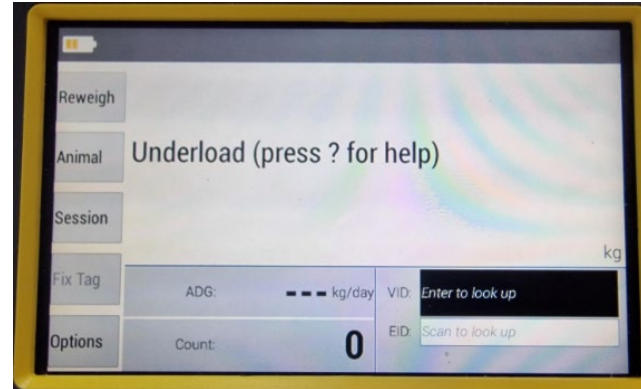

# Telemetry Subsystem Enabled

We have included a telemetry subsystem to the 5000 series that collects data in the background.

When customers use the WIFI upload to cloud option, the data collected by the telemetry will be send to our server.

We can use this data to debug issues, and collect information on device performance.

No customer data is collected, and this does not affect the performance of the device.

